

**BRITVIC**

**RESTARTING YOUR SOFT  
DRINKS SYSTEM AFTER  
TEMPORARY SHUTDOWN**



For further support please visit  
[www.britvicequipment.com](http://www.britvicequipment.com)

# COOL LOW RESTART GUIDE



# SUMMARY OF THE STEPS

Preparation- Items required to complete the restart process

1. Check and turn on your CO2
2. Open water supply to soft drinks system
3. Reset soft drinks carbonator
4. Reset soft drinks cooler with built in carbonator
5. Cooler digital control information
6. Clean all BIB connectors and check BIB dates
7. Turn on power to dispense heads
8. Replenish carbonated water
9. Replenish In Date BIB
10. Replenishing Out Of Date BIB flushing process
11. Cleaning the dispense head
12. Final quality checks in readiness to serve

## PREPARATION



Firm cleaning brush /  
Thirst Aid Kit



Paper Towel



Mild detergent  
(washing up liquid)



Pair of Scissors



Clean cloths



Sufficient CO2



Food grade measuring  
container and  
graduated bucket



New BIB to replenish stock  
if empty or Out Of Date



PPE as required

## TURN ON CO2

Needs to be in the green area on the content gauge and reading 600PSI as a minimum.



## OPEN WATER SUPPLY TO SOFT DRINKS SYSTEM

Closed Position

Open Position



Examples of different types of water isolation valves.

## RESET SOFT DRINKS CARBONATOR

Switch off at plug for 5 seconds then switch back on.

If the Carbonator is plugged directly into Soft Drinks Cooler, switch off cooler at the plug for 5 seconds then switch back on again.



If you do not have a standalone Carbonator see next step

## RESET SOFT DRINKS COOLER WITH BUILT IN CARBONATOR

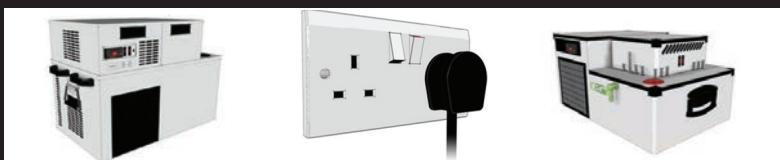

If you do not have a standalone carbonator it will be built in to the soft drinks cooler.

To reset your Soft Drinks cooler switch off at the plug for 5 seconds then switch back on again.

## COOLER DIGITAL CONTROLLER INFORMATION

If cooler controller displays EN5 (Energy Saving Mode) then remove clear protective cover and press the return button on the top right.



Information- this specific DFX digital Controller is not fitted to all Britvic Coolers

## CLEAN ALL BIB CONNECTORS AND CHECK BIB DATES



Check all BIB's and remove all out of date BIB products.

Using the food grade container, clean all of the bag in box connectors in hand hot water spinning the outer collar in the process.

Dry with paper towel before reconnecting.

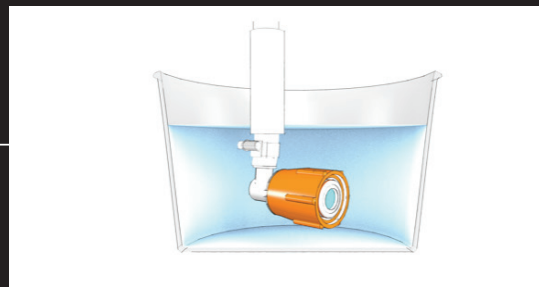

## TURN POWER ON TO THE DISPENSE HEAD AT SOCKET AND TRANSFORMER



## REPLENISH CARBONATED WATER

For each action below only pour from one dispense head at a time

Go to the furthest dispense head on the system.

Press the soda lever (usually fitted to the Lemonade valve) and pour 15L of carbonated water.

For any additional dispense heads on the system pour a further 2L of carbonated water on each.



## REPLENISHING IN DATE BIB SYRUPS

For each action below only pour from one dispense head at a time



Pour 1 Litre of finished drink for each product

Repeat on all dispense heads

# REPLENISHING OUT OF DATE BIB- FLUSHING PROCESS

CRITICAL - Ensure you only connected like for like BIB

1

Take an empty/used BIB and take out the bag inside  
Cut out the bag valve with a pair of scissors.

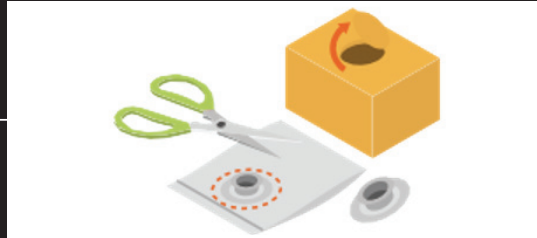

2

Rinse valve thoroughly.

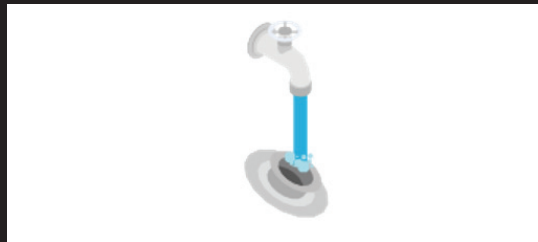

3

Fill food grade container with a minimum of 10L of clean cold water.



4

Starting with a dark BIB product first. e.g. Pepsi Max.

Connect the bag valve to the Pepsi Max line you want to flush.

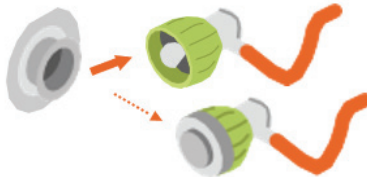

5

Immerse the BIB connector and fitment completely in water.

Ensure it stays immersed.

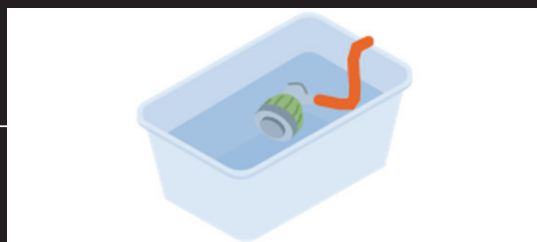



## Graduated Bucket required for this step

6

Go to the furthest dispense head on the system and pour Pepsi Max until the stream turns clear.



The change in colour indicates the out of date syrup has been removed from the line.

Keep a note of the amount poured as this assists with the volume required to pull through on a clear syrup such as Lemonade

7

Repeat on all other dispense heads for Pepsi Max.



8

Remove BIB connector from the water.  
Unscrew cleaning fitting from BIB connector.

Keep cleaning adaptor for other products if required.

9

Connect new in date BIB.



## Graduated Bucket required for this step

# 10

Go to the furthest dispense head on the system and pour Pepsi Max until the stream turns dark



The change in colour indicates the water has been replaced by new syrup in the line

This will be the same amount of liquid when the line was flushed

# 11

Repeat on all other dispense heads for Pepsi Max.



The flushing process is now complete  
**REPEAT FOR ALL OTHER OUT OF DATE BIB**

# CLEANING THE COOL LOW DISPENSER

1

Rotate nozzle and pull down to remove.



2

Separate the nozzle and diffuser.



3

Clean the nozzle and diffuser thoroughly in hand-hot soapy water with a brush, rinse with water and dry with paper towel.

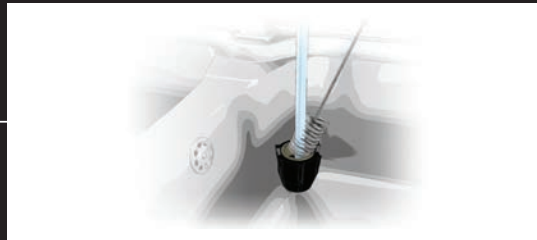

Never leave in soak

4

Re-fit the diffuser into the nozzle with the O-ring facing up.



5

Push the nozzle and diffuser into valve and rotate to lock into position.



6

Wipe all external surfaces with a clean damp cloth.



## FINAL CHECKS

Ensure Soft Drinks cooler has been on for 3 hours.

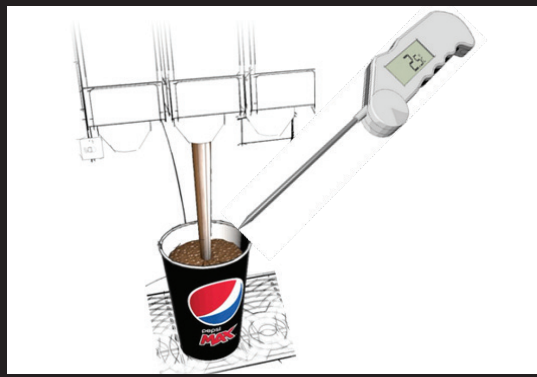

Pour one full cup and discard, pour a second full cup and check the temperature (must be lower than 4.4°C). A temperature indicator is also available in the Britvic Thirst Aid Kit if no temperature probe is available.

Taste one full cup for carbonation and flavour.



**IF ALL SATISFACTORY  
THEN YOU CAN NOW SERVE**